

## Assembly of PolDeck BD

### 1 Setting the first panel

Shape of profiling PolDeck BD does not allow for potential correction of the length in the ridge. For correct assembly, first panel should be set **on the axis of construction** setting **straight line in the ridge**, not in relation to top or eave. Lack of perfect line of panels in eave (the so-called „teething”) is not failure, cause it will be covered by flashings. Determinant of the assembly line is an even ridge line.

**CAUTION:** The correct installation of panels PolDeck BD is only possible in one direction: **from left to right**.

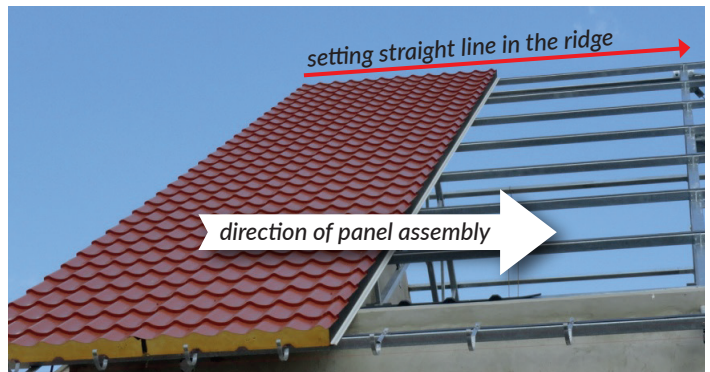

### 2 Preparing panels for montage

Roof panels PolDeck BD should be selected in pairs before putting them on the construction. In this case you should make auxiliary station by setting 4 panels on the secured ground for example styrofoam spacers **[1]**. Making pairs of panels, it means placing first panel on the secured ground, next second and other panels overlaps on each other **[2]** and fix until the moment, when the sound of descent of roof profiling will appear. **[3]**.

Place the next panel with ca. **50 mm** gap on length at the edge. Then make an upward push of the new panel to the top in order to close gaps of the tiles. As the panel closes with a final tolerance per length on top side of up to 10mm the panels are paired correctly. If length non-alignment exceeds 10 mm, replace panel for a new one and try again. If tolerance on lengths of adjacent panels in eave exceeds **10 mm**, the other panel should be taken and tried again. If the line inequality is within 10mm, the panels are matched correctly **[4]**.

It is recommended to pair at least 4 panels at the same time. Last panel stays on preparing station to continue the process of matching and so on.. The most important thing in this stage is keeping an even the of panels PolDeck BD in ridge. In case of lack of this condition, you should take next panels to match. The **slots on tile joints** (of various lengths) **does not make defect** and any obstacles due to the slope angle of the roof (minimum 12° / 21 %) and used drainage gutter in edge of panels joint.

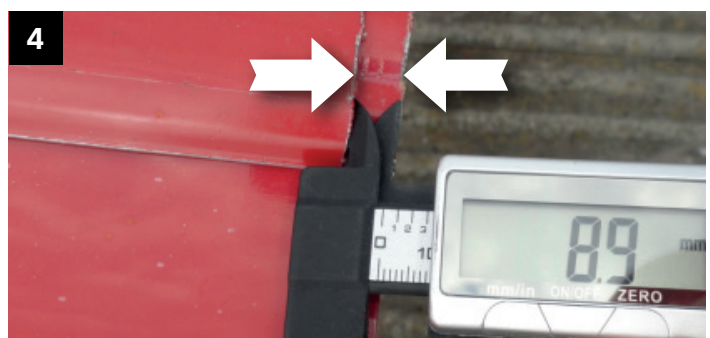
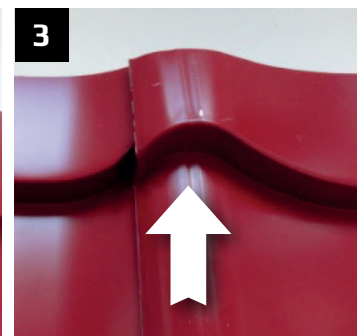
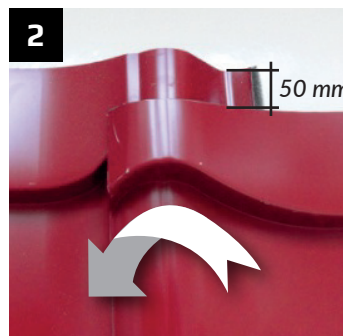

### 3 Assembly of other panels

Paired panels PolDeck BD, **shall be moved on the sub-construction after removing protective film from the panels**. Removing foil after assemble is impossible, because of vulcanization effect. Next panel shall be placed on the installed one **[1]** in the way that overlap the connection and placed about 50mm below the previous one (like it was done in matching faze) panel shall be pushed to the ridge direction **[2]** till the moment of hearing the sound of descent of the roof profiling, then pushed to the previous panel direction **[3]** longitudinally and this positioned panel shall be fixed to the construction.



## 4 Amount and placement of screws

- *Amount and placement of screws stitching the fold of the hem:* on the top of each roof tile around 330mm (best at the middle of roof tile profiling)

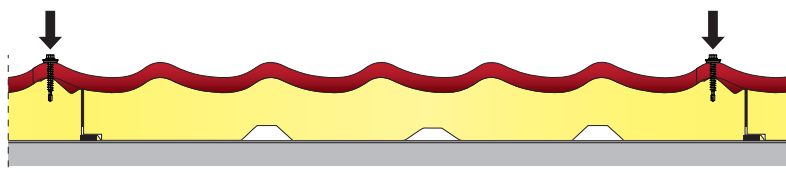

- *Middle zone of roof:* at least 3 joints in every purlin in width of panels

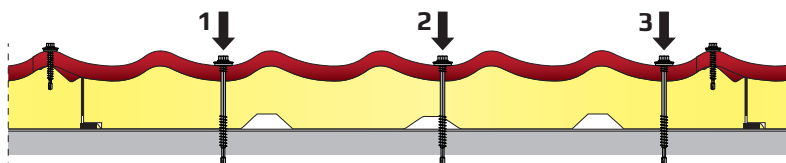

- *Edge line and edge (top and last purlin):* in every dell in every purlin

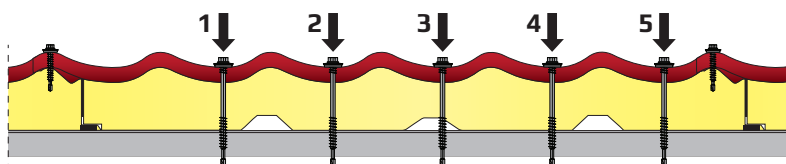

To assemble use screws with gasket. Minimum width of purlin 40mm extern and 60mm middle.

**CAUTION:** After assemble **remove all metal filings from the surface of the panels immediately!!**

## 5 Okap

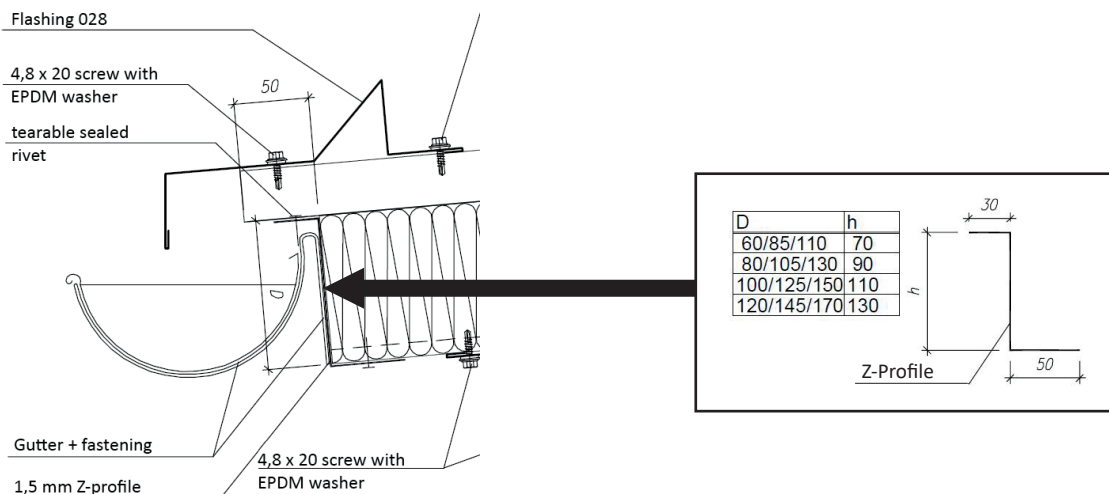

It is recommended to order PolDeck BD with undercut 50mm for gutter assembly with z-profile (drawing above). All of that can be covered from the top by flashing 028, making also snow barrier and eave assembled to every upper wave of roof tiles.

If solution with hooks is used then the best solution is to use wooden boards and eave made of metal sheet 1,0mm placed between upper coating and core of panel. Eave covers board which is mounted to it and at the same time it is the base to assemble the hooks.

